

Art Gallery of Swift Current's
**SECOND ANNUAL
MEMBER'S SALON AND
SALE**

November 30, 2022 – January 3, 2023



Who can submit?

You must:

- Be 18 years of age or older
- Be a resident of Saskatchewan
- Possess a current AGSC membership

Don't have a membership?

Visit Art Gallery of Swift Current @ 411 Herbert Street East, give us a call at

306-778-2736 or check online **www.artgalleryofswiftcurrent.org** to purchase your membership.

What can I submit?

- Wall work (2-dimensional art that can be easily hung on the wall such as paintings, drawings, tapestry, etc.)
- Plinth/stand-alone work (3-dimensional art such as sculpture, jewelry, and pottery)
- **ALL** work must be ready for display. (see pg 6,8,9 for tips and guidelines)
- Work submitted must not have been shown in a previous Member's Salon and Sale at AGSC.

Artwork must be original. No reproductions, copies, or work made from a commercial kit will be accepted.

The person submitting the artwork must be the creator.

Work created in a class or workshop is encouraged and should be identified.

Dates to remember

November 7, 2022: Deadline to submit your entry form and artwork information. This includes labels, and photos of your artwork.

No late submissions will be accepted.

November 14-18, 2022: Artwork Delivery week.

Artwork will not be accepted after November 18th, @ 5:00pm

December 9th, 2022: Public Reception at 7:00pm

January 3, 2023: Last day of Salon and Sale

January 4 – 7, 2022: Artwork pickup dates

How to Submit

Fill out the form on page 5 and submit it one of the following ways:

- Email your form and photos to agscprograms@swiftcurrent.ca (**Preferred**)
- Drop off or mail your form to:
Art Gallery of Swift Current
411 Herbert Street East
Swift Current, SK
S9H 1M5
- Please **TYPE** your information clearly. No handwriting, please.
- **Please note:** As a Member of AGSC, you are guaranteed to have at least one piece displayed in the show. We cannot guarantee all pieces submitted will be displayed.

When filling out your form:

- Email photographs of the artwork(s) you are submitting for the *Members' Salon and Sale* to: agscprograms@swiftcurrent.ca
- **Subject line:** Salon and Sale
- Send your images as attachments, not embedded in the body of the email
- Ensure that the artwork label information is correct. Legal name, phone number, email, and mailing address.

(Cheques from artwork sales will be mailed to the address provided).

Send your form & images by November 7th, 2022.

Late submissions will not be accepted.

Please note: All submitted artworks must be ready for display.

See pages 6, 8 and 9 for information about displaying your artwork.

Dropping off your Artwork to the Gallery:

- Drop off dates are **November 14th to 18th, 2022**.
- Have your name, Title of artwork, and year labelled clearly on the back (Or bottom – 3-dimensional work)
- Due to limited storage space, we ask that you please unwrap your work and take your packing materials back with you after dropping off your work.
- If you have unique wrapping or cards for your artwork in case of purchase, we can make arrangements to keep them on hand.
- Business cards are welcome and encouraged! We will have them at the front for gallery visitors.

Picking up your Artwork from the Gallery:

- Pick-up dates for any unsold artwork are **January 4th to 7th, 2023**.
AGSC Staff will send out correspondence for sold artwork via email.
- Participants will be responsible for wrapping up unsold artworks. Please remember to bring your packing materials for pick up.
- AGSC Staff will wrap up any artwork that has been sold.

Member's Salon and Sale Submission Form:

NAME:	TOWN/CITY
PHONE:	EMAIL:
MEMBERSHIP NUMBER:	MAILING ADDRESS:

Label Information

Please TYPE clearly
Each Member may submit up to THREE pieces for consideration.

TITLE	YEAR COMPLETED	MATERIALS USED (Paint, Clay, Pastel, Etc)	PRICE
1.			
2.			
3.			

Please include photos of up to 3 artwork(s) you would like to submit to: agscprograms@swiftcurrent.ca

Wall Artwork Guidelines

Primarily two-dimensional works, framed or on canvas, that can easily be hung with one or two nails.

- Larger Canvas pieces must be prepared for hanging with D-rings. (D-rings available at the Art Gallery of Swift Current if needed)
- Framed pieces must be in sturdy frames.
- Pieces may also be hung with magnets, clips or mirror hooks.

Work must be in sellable condition:

- Clean (Free from stains and smudges)
- Fully dried
- Frames should be clean and sturdy
- Canvas supports should not be warped or coming loose
- No loose or shoddy construction (all pieces well-affixed)
- Completed (no works in progress)
- Fragile surfaces (such as pastel or charcoal) should be fixed with spray fixative OR behind glass in a frame
- Undamaged

Plinth/Stand-alone Artwork Guidelines

Plinth work includes sculpture and three-dimensional work that is not suitable for wall hanging.

- Work must be able to sit/stand safely on its own.
- Smaller work will be set on a Plinth

Work must be in sellable condition:

- Clean (Free from stains, smudges)
- Thoroughly dried/fired
- Made from stable materials
- Pottery should be free from cracks, unless intentional
- Please label pottery that is not food-safe

Pricing your Artwork

- All submitted work must be for sale
- Price your work thoughtfully.

Consider:

- The labour and cost of materials in your work,
- What are people likely to pay for artwork, and
- How other Salon & Sale participants are pricing their work

Also consider that a 20% commission of all artwork sales will support the Art Gallery of Swift Current (AGSC).

Sales

By submitting your work to the Member's Salon and Sale, you agree to contribute 20% of sales to the AGSC.

- Following the Member's Salon and Sale's closing, cheques will be mailed from Swift Current City Hall with the balance of 80% of the total sale proceeds. Please contact us if you do not receive your cheques within 30 days of the show's end date.
- We cannot share purchaser information without permission. We recommend that you include a business card or thank you card with your artwork so buyers may contact you if they wish.

How to wire work for hanging

All wall pieces **MUST** be ready to be hung with nails, magnets, clips or mirror hooks.

When hanging canvases or larger frames- wires must be present.

Step 1: Affix D-rings to back of frame/stretcher with screws, 1/3 of the total height from the top of the piece, at equal measurements.

Professionally framed work or commercial frames may already have these.

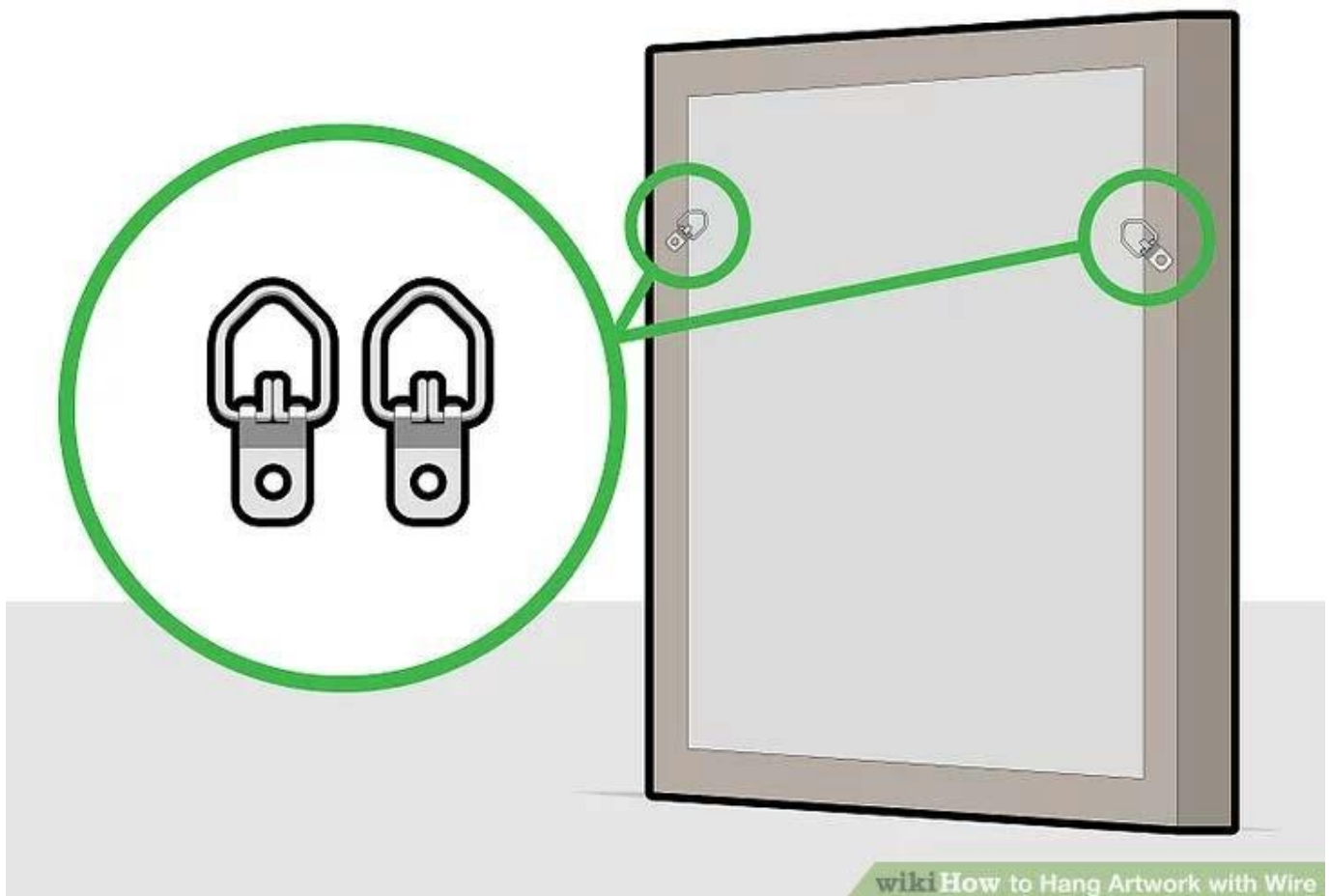

Tying Wire

Cut a piece of wire 4- 6" wider than the frame.

Loop one end of wire about 2 inches through D-Ring and **follow wire tying steps 1-4.**

Repeat on the other D-Ring leaving a small amount of slack in the wire.

TIP: If the wire is too tight it decreases its strength, if too loose the art will tilt away from the wall.

